

High Power LED

BL-HP9EXX

Features:

- ∅ 1W LEDs , suitable for illumination lamps and decorative lighting
- ∅ Longer service and less luminosity loss, 50,000hours
- ∅ Different emitting colors are available Working current: 200-350mA
- ∅ With or without heat sink are both available

Applications:

Commercial lighting
Residential lighting
Decorative lighting



1Watt Lambertian

Electrical-optical characteristics: (Ta=25°C)

Part Number	Chip		Lens Type	Forward Voltage(VF) Unit: V		Flux Unit:lm		Viewing Angle 2θ/2 (deg)
	Emitted Color	λ _p (nm) or CTT		Typ	Max	Min.	Typ.	
				Water Clear				
BL-HP9EUEC	Ultra Orange	630		2.2	2.75	35	45	
BL-HP9EUYC	Ultra Yellow	590		2.2	2.75	35	45	
BL-HP9EPGC	Ultra Pure Green	525		3.2	3.8	50	60	
BL-HP9EBGC	Ultra Bluish Green	505		3.2	3.8	40	50	
BL-HP9EUBC	Ultra Blue	470		3.2	3.8	10	15	
BL-HP9EUWC	Ultra White	6000k		3.2	3.8	70	90	
BL-HP9EUW2C	Ultra Warm White	3200k		3.2	3.8	50	70	

Absolute maximum ratings (Ta=25°C)

Parameter	UE	UY	BG	PG	UB	UW	Unit
Forward Current I _F	350	350	350	350	350	350	mA
LED Junction Temperature	120	120	120	120	120	120	°C
Peak Forward Current I _{PF} (Duty 1/10 @1KHZ)	500	500	500	500	500	500	mA
Operation Temperature T _{OPR}	-40 to +80						°C
Storage Temperature T _{STG}	-40 to +100						°C
Aluminum-Core Pcb Temperature	105						°C

Package configuration & Internal circuit diagram

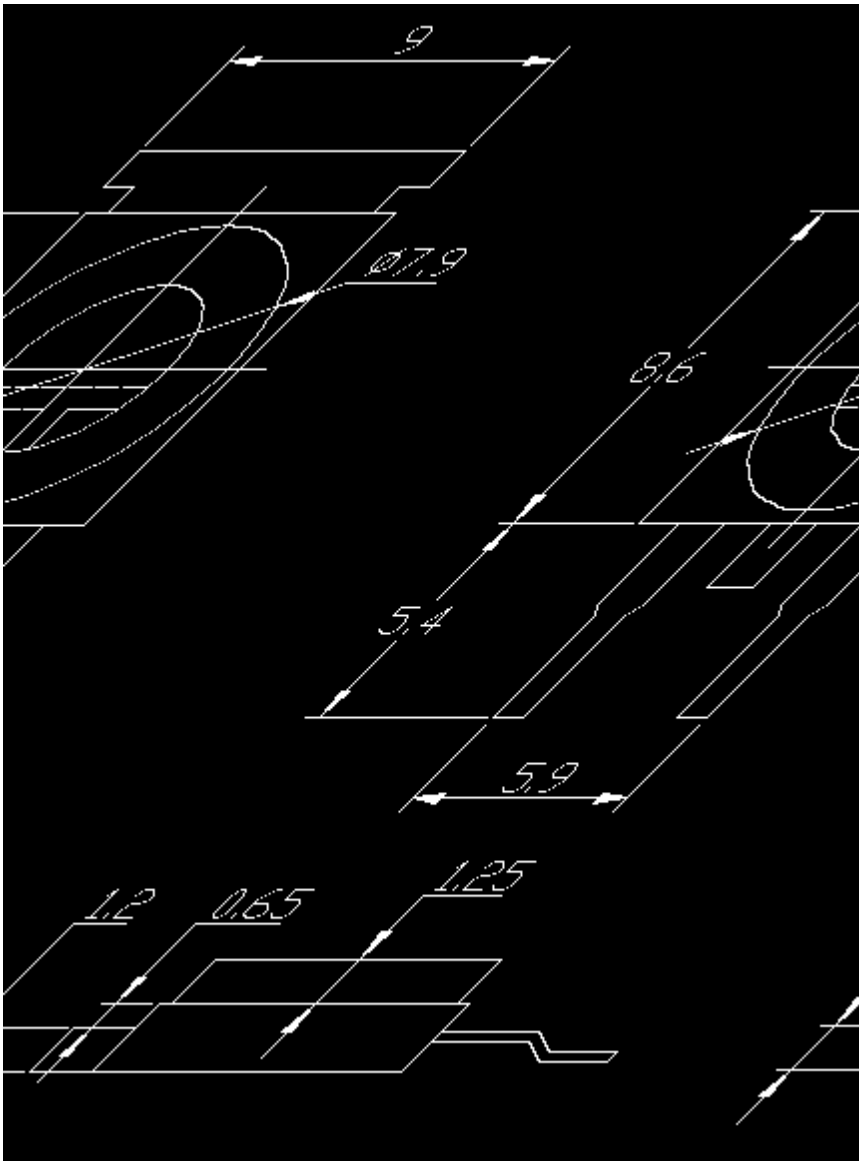

Notes:

1. All dimensions are in millimeters (inches)
2. Tolerance is 0.25(0.01")unless otherwise noted.
3. Specifications are subject to change without notice.

High Power LED

BL-HP9EXX

Typical electrical-optical characteristics curves:

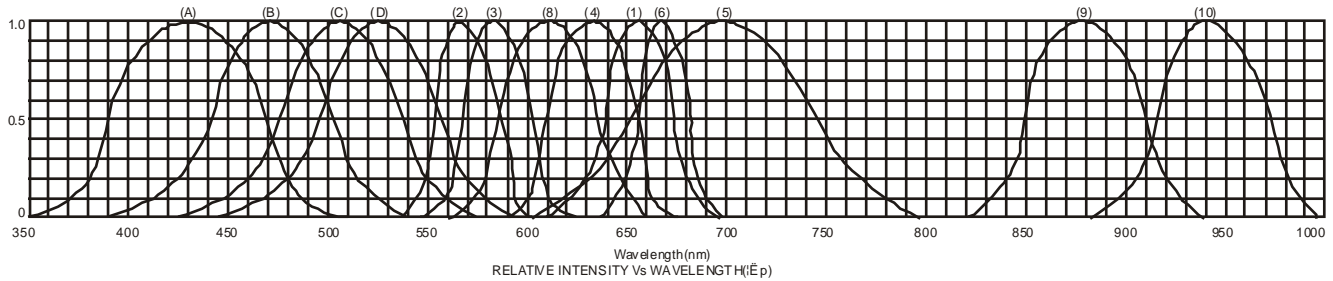

- (1) - GaAsP/GaAs 655nm/Red
- (2) - GaP 570nm/Yellow Green
- (3) - GaAsP/GaP 585nm/Yellow
- (4) - GaAsP/GaP 635nm/Orange & Hi-Eff Red
- (5) - GaP 700nm/Bright Red
- (6) - GaAlAs/GaAs 660nm/Super Red
- (8) - GaAsP/GaP 610nm/Super Red
- (9) - GaAlAs 880nm
- (10) - GaAs/GaAs & GaAlAs/GaAs 940nm
- (A) - GaN/SiC 430nm/Blue
- (B) - InGaN/SiC 470nm/Blue
- (C) - InGaN/SiC 505nm/Ultra Green
- (D) - InGaAlSiC 525nm/Ultra Green

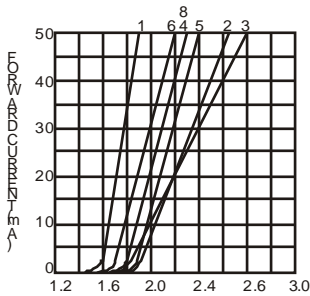

FORWARD VOLTAGE (V)
FORWARD CURRENT VS.
FORWARD VOLTAGE

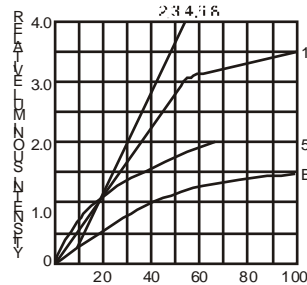

FORWARD CURRENT (mA)
RELATIVE LUMINOUS
INTENSITY VS. FORWARD
CURRENT

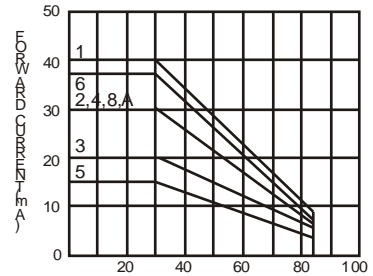

AMBIENT TEMPERATURE Ta ()
FORWARD CURRENT VS. AMBIENT
TEMPERATURE

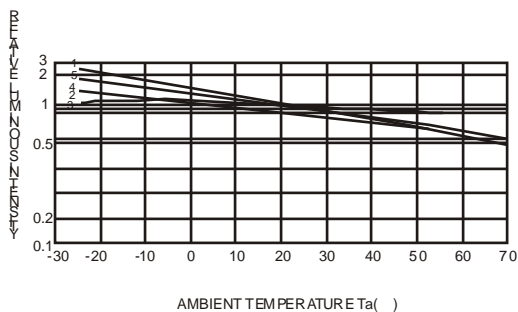

AMBIENT TEMPERATURE Ta ()

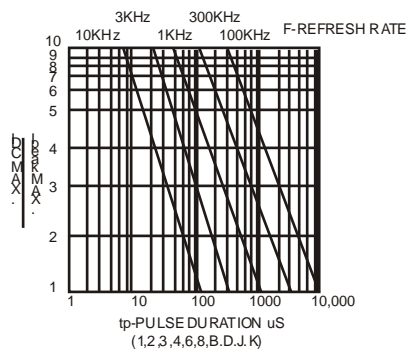

tp-PULSE DURATION µs
(1,2,3,4,6,8,B,D,J,K)

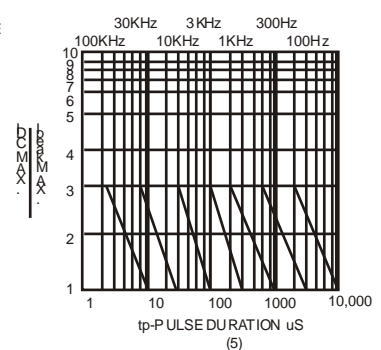

(5)

NOTE: 25 free air temperature unless otherwise specified

High Power LED

BL-HP9EXX

Packing and weighting

